

**Specifications**

Nominal Voltage		12 V
Capacity (25°C)	10HR(10.8V)	75 Ah
	5HR(10.5V)	62 Ah
	1HR(9.60V)	46.1Ah
Dimension	Length	260mm ± 2 (10.24inch)
	Width	168mm ± 2 (6.61inch)
	Height	215mm ± 2 (8.46inch)
	Total Height	215mm ± 2 (8.46inch)
Approx. Weight		24.0kg (52.9lbs) ± 4%
Terminal type		T9
Internal resistance (Fully charged, 25°C)		Approx. 6.80m Ω
Capacity affected by temperature (10HR)	40°C	102%
	25°C	100%
	0°C	85%
	-15°C	65%
Self-discharge (25°C)	3 month	Remaining Capacity: 94%
	6 month	Remaining Capacity: 88%
	12 month	Remaining Capacity: 75%
Nominal operating temperature		25°C ± 3°C (77°F ± 5°F)
Operating temperature range	Discharge	-15°C ~ 50°C (5°F ~ 122°F)
	Charge	-10°C ~ 50°C (14°F ~ 122°F)
	Storage	-20°C ~ 50°C (-4°F ~ 122°F)
Float charging voltage(25°C)		13.50 to 13.80V Temperature compensation: -18mV/°C
Cyclic charging voltage(25°C)		14.10 to 14.40V Temperature compensation: -30mV/°C
Maximum charging current		15.0A
Terminal material		Copper
Maximum discharge current		520A(5 sec.)
Designed floating life(20°C)		15 years

- ◆ Gelled electrolyte technology;
- ◆ PVC separator;
- ◆ Recognized by UL & CE;
- ◆ ABS container.



**Dimensions**

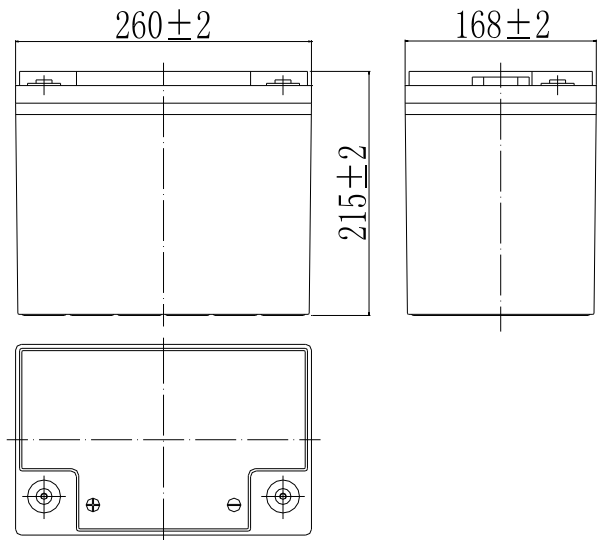

**Terminal**

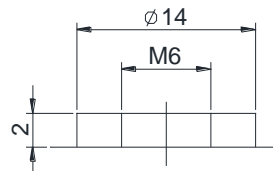

Terminal T9

**Constant Current Discharge Characteristics (A, 25°C)**

F.V/TIME	15min	30min	1h	2h	3h	4h	5h	8h	10h	20h
9.60V	118	81.8	46.1	26.1	18.5	14.6	12.7	8.87	7.80	4.44
9.90V	114	79.4	44.7	25.7	18.3	14.5	12.6	8.78	7.73	4.36
10.2V	109	76.1	42.9	25.4	18.2	14.4	12.5	8.70	7.65	4.28
10.5V	105	72.8	41.1	25.0	18.0	14.3	12.4	8.63	7.58	4.18
10.8V	98.8	68.7	38.7	24.3	17.5	13.8	12.0	8.37	7.50	4.09

**Constant Power Discharge Characteristics (Watt, 25°C)**

F.V/TIME	15min	30min	1h	2h	3h	4h	5h	8h	10h	20h
9.60V	1312	928	526	304	65	172	150	106	93.6	53.5
9.90V	1273	900	510	300	214	171	149	105	92.7	52.5
10.2V	1221	863	489	295	212	169	148	104	91.8	51.6
10.5V	1168	826	468	291	211	168	146	103	90.9	50.4
10.8V	1102	779	442	283	204	163	142	100	90.0	49.3

Note: The above characteristics data can be obtained within three charge/discharge cycles.

Discharge Characteristics(25°C)

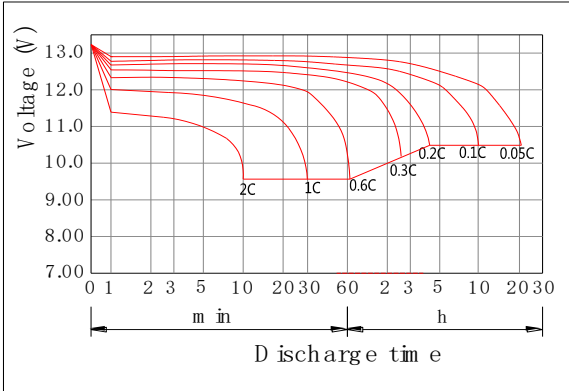

Charging Characteristics(25°C)

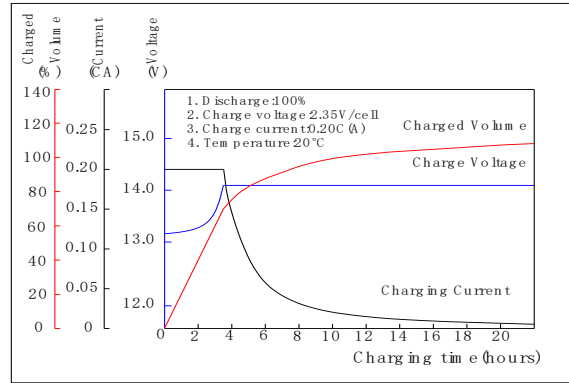

Effect of Temperature on Capacity

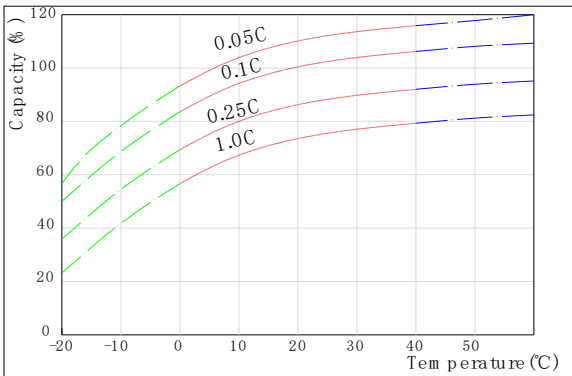

Self-discharge Characteristics

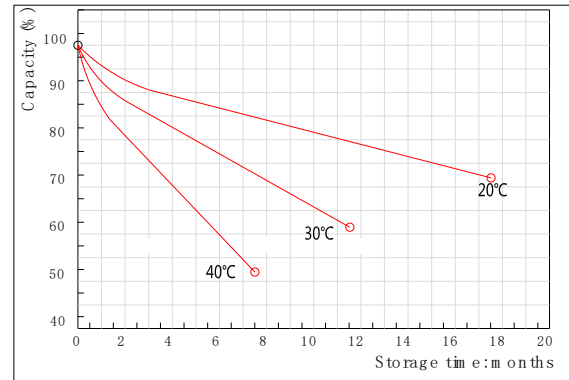

The Relationship for Open Circuit Voltage and Residual Capacity (25°C)

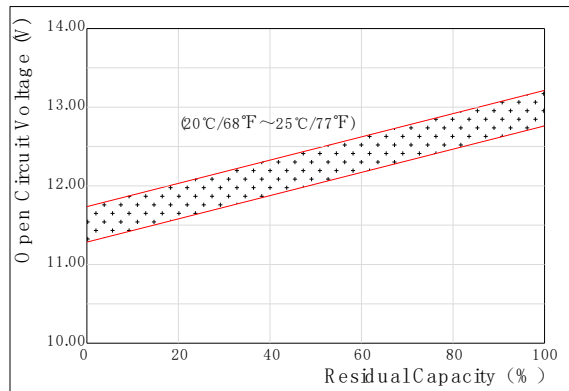

The Relationship for Charging Voltage and Temperature

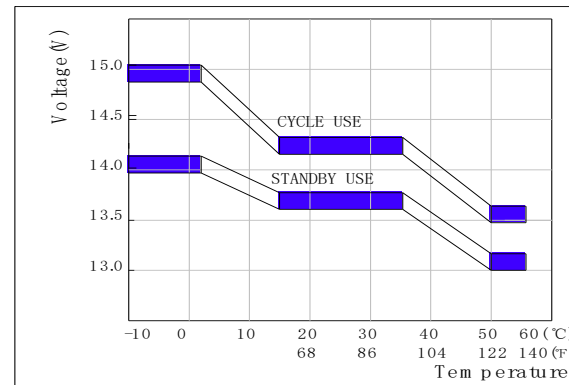

Floating Life on Temperature

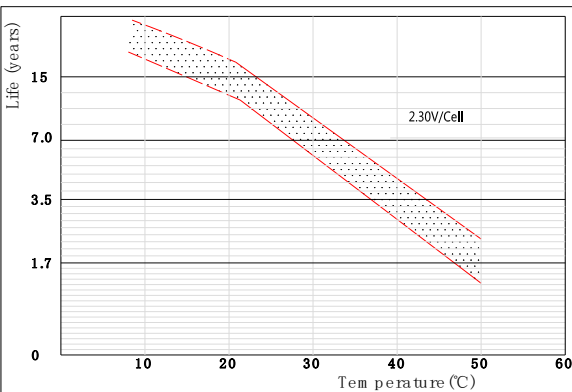

Cycle Life on D.O.D(25°C)

