

Specification

Nominal Voltage	12V	
Nominal Capacity(20hr)	14Ah	
Dimensions	Length	152 ±1mm
	Width	99 ±1mm
	Container Height	96 ±1mm
	Total Height (with Terminal)	102 ±1mm
Approx Weight	Approx 3.8 kg	
Terminal	T1	
Container Material	ABS	
Rated Capacity	14.0 AH/1.0 A	(20hr, 1.80V/cell, 25°C)
	12.6 AH/1.26A	(10hr, 1.80V/cell, 25°C)
	12.0 AH/2.30A	(5hr, 1.75V/cell, 25°C)
	8.5 AH/8.5A	(1hr, 1.60V/cell, 25°C)
Max. Discharge Current	195A (5s)	
Internal Resistance	Approx 15mΩ	
Operating Temp. Range	Discharge : -15~50°C	
	Charge : 0~40°C	
	Storage : -15~40°C	
Nominal Operating Temp. Range	25±3°C	
Cycle Use	Initial Charging Current less than 3.6A. Voltage 14.4V~14.9V at 25 °C Temp. Coefficient -30mV/°C	
Standby Use	No limit on Initial Charging Current Voltage 13.6V~13.8V at 25 °C Temp. Coefficient -20mV/°C	
Capacity affected by Temperature	40 °C	102%
	25 °C	100%
	0 °C	85%
Self Discharge	PBC series batteries may be stored for up to 6 months at 25 °C and then a freshening charge is required. For higher temperatures the time interval will be shorter.	



Applications

- ◆ Electric tools
- ◆ Vehicle in place of walking
- ◆ Lawn mowers
- ◆ Golf trolleys and golf cart
- ◆ Portable apparatus, lights and instruments;
- ◆ Electric toys
- ◆ Illumination light
- ◆ Fire alarms
- ◆ Portable power
- ◆ Wheelchairs
- ◆ Medical equipments.



Constant Current Discharge (Amperes) at 25 °C (77°F)

F.V/Time	5min	10min	15min	30min	45min	1h	2h	3h	5h	8h	10h	20h
1.60V	46.2	30.8	23.2	15.4	10.8	8.5	5.2	4.0	2.5	1.8	1.39	0.77
1.65V	45.4	30.2	22.8	15.1	10.6	8.3	5.1	3.9	2.4	1.7	1.36	0.76
1.70V	44.5	29.7	22.3	14.8	10.4	8.2	5.0	3.8	2.4	1.7	1.34	0.74
1.75V	43.7	29.1	21.9	14.6	10.2	8.0	5.0	3.7	2.3	1.7	1.31	0.73
1.80V	42.0	28.0	21.1	14.0	9.8	7.7	4.8	3.6	2.2	1.6	1.26	0.70

Constant Power Discharge (Watts/cell) at 25 °C (77°F)

F.V/Time	5min	10min	15min	30min	45min	1h	2h	3h	5h	8h	10h	20h
1.60V	88.9	59.3	44.6	29.6	20.8	16.3	10.1	7.6	4.8	3.4	2.7	1.5
1.65V	87.3	58.2	43.8	29.1	20.4	16.0	9.9	7.5	4.7	3.4	2.6	1.5
1.70V	85.7	57.1	43.0	28.6	20.0	15.7	9.7	7.3	4.6	3.3	2.6	1.4
1.75V	84.1	56.1	42.2	28.0	19.6	15.4	9.5	7.2	4.5	3.2	2.5	1.4
1.80V	80.9	53.9	40.6	27.0	18.9	14.8	9.2	6.9	4.4	3.1	2.4	1.3

Dimensions

T1 Terminal

Unit: mm

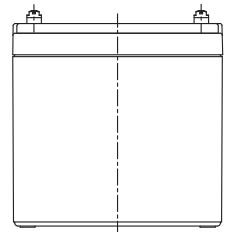
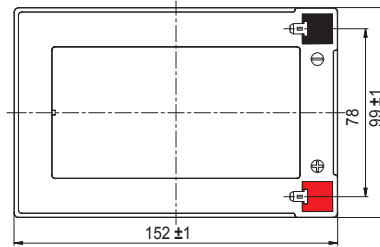
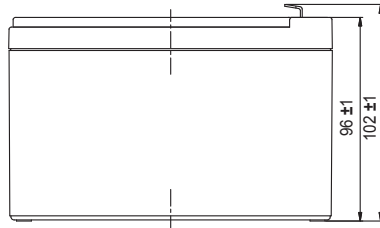
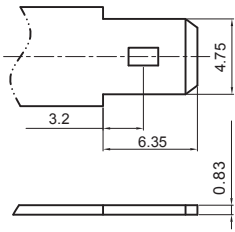

Discharge Characteristics

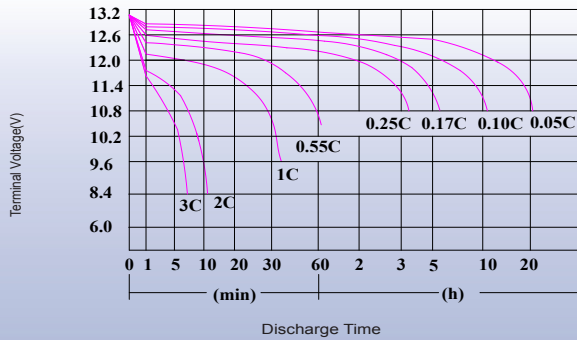

Float Charging Characteristics

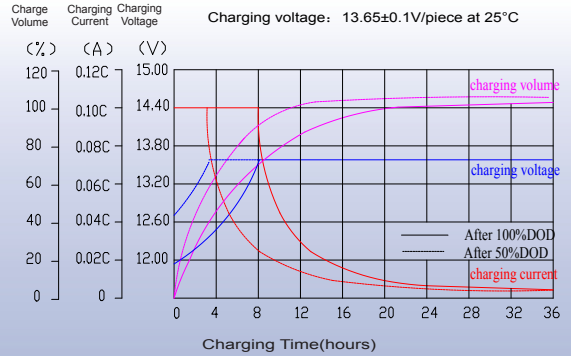

Temperature Effects in Relation to Battery Capacity

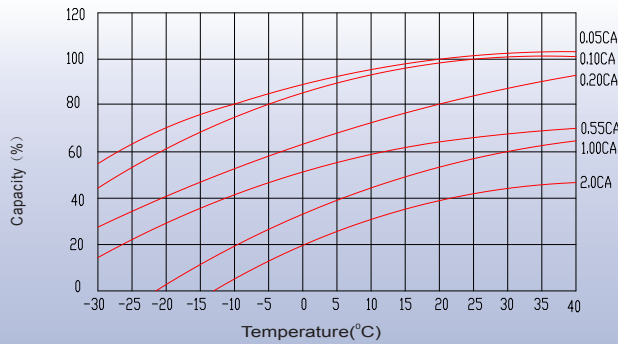

Effect of Temperature on Long Term Float Life

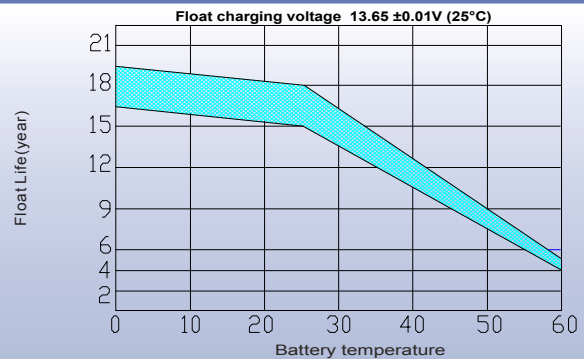

Cycle Life in Relation to Depth of Discharge

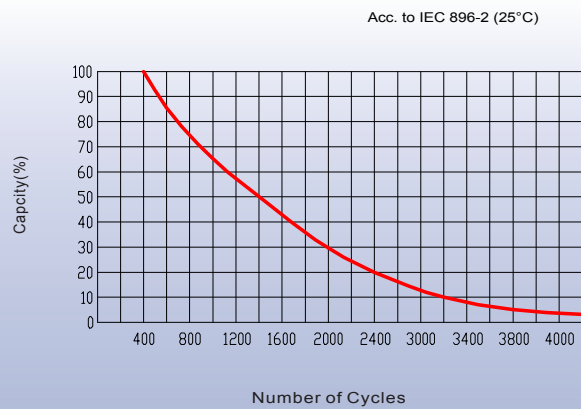

Self Discharge Characteristics

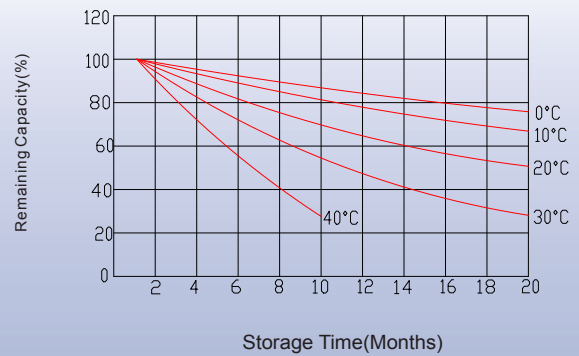

Contact